

# Sanctuary Cove

**2 Bedroom 2 Bath**

**1,179 Square Feet**

**Starting at \$1,199**

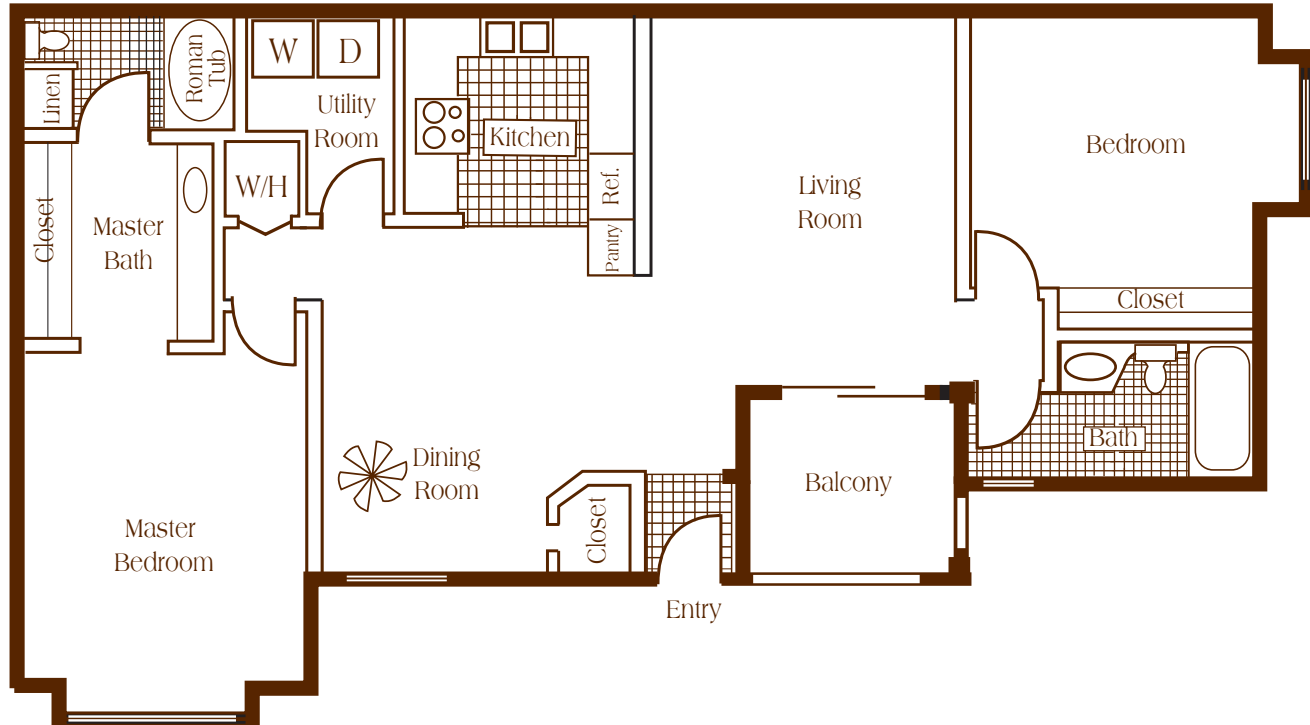

## INTERIOR FEATURES

- **INTRACOASTAL AND LAKEFRONT VIEWS AVAILABLE**
- **INDIVIDUAL ENTRANCES**
- **FULLY APPOINTED KITCHEN**
- **FULL SIZE WASHER AND DRYER**
- **DECORATIVE CERAMIC TILE ENTRY, KITCHEN AND BATH**
- **CEILING FAN IN DINING AREA**
- **MARBLE ROMAN TUB**
- **TRAY CEILINGS IN SELECT APARTMENT**
- **SCREENED PATIO OR BALCONY**

## INTRACOASTAL FEATURES

- **PRIVATE WHITE SAND BEACH**
- **WATERFRONT POOL AND BAR**
- **BBQ AREA**
- **SPECTACULAR VIEWS AVAILABLE**

**MON, WED & FRI: 8AM-6PM**  
**TUES & THURS: 8AM-8PM**  
**SAT & SUN: 9AM-6PM**

## RECREATIONAL FEATURES

- **TROPICAL POOLS AND SPA**
- **24 HOUR FITNESS CENTER AND AEROBIC STUDIO**
- **LIGHTED TENNIS COURT**
- **COMMUNITY PARK NEXT DOOR FEATURING BASKETBALL, PLAYGROUND AND BASEBALL FIELD**

PRICES SUBJECT TO CHANGE WITHOUT NOTICE

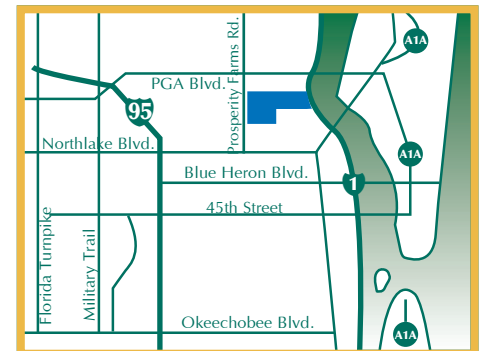

**SANCTUARY COVE**  
**700 SANCTUARY COVE DRIVE**  
**NORTH PALM BEACH, FLORIDA 33410**

**PHONE: 561.775.8680**  
**FAX: 561.691.5836**

[WWW.SANCTUARYCOVEAPARTMENTS.COM](http://WWW.SANCTUARYCOVEAPARTMENTS.COM)